

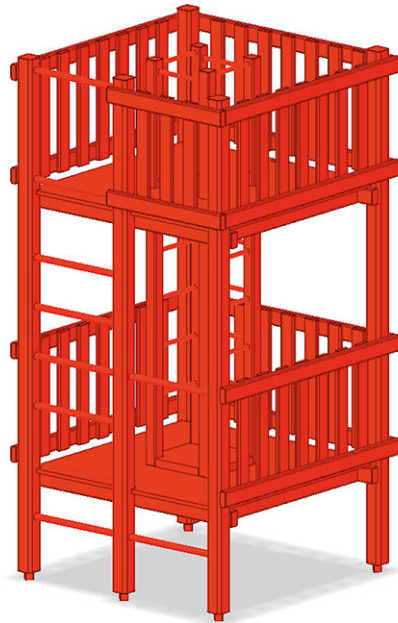



Basic tower square timber

Article B-03-120

Basic square timber tower for platform heights 25/200 cm, base area 170 x 170 cm, pressure impregnated pine beams, with rung ascent and built-in rung chimney from the lower to the upper platform.



CHF 6'020.-
(excl. VAT)

 Fall height	200 cm
 Assembly time	1 h
 Installers	2