

Basic tower square timber

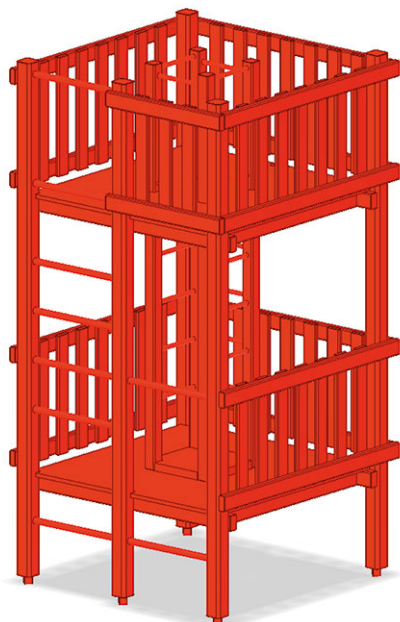

Article B-03-130

Basic square timber tower for platform heights 70/245 cm, base area 170 x 170 cm, pressure impregnated pine beams, with rung ascent and built-in rung chimney from the lower to the upper platform.



CHF 6'165.-

(excl. VAT)

 Fall height	245 cm
 Assembly time	1 h
 Installers	2