

Fundament F01

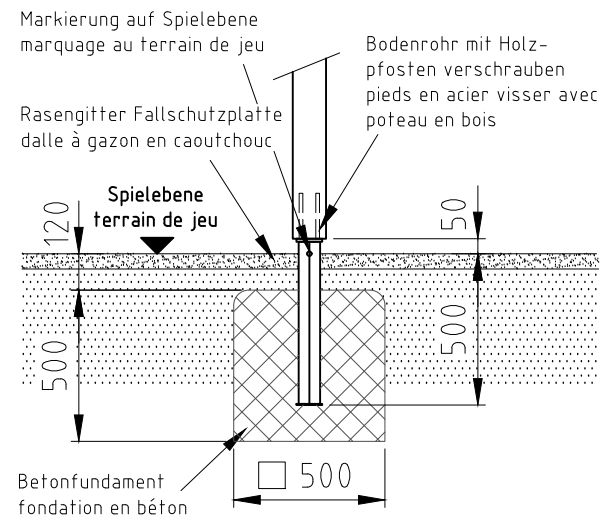

H= Fallhöhe
H= espace de chute

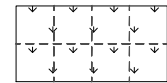

Aufprallfläche 0-100cm
espace de chute 0-100cm

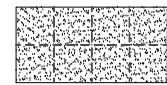

Aufprallfläche 0-180cm
espace de chute 0-180cm

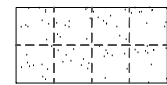

Aufprallfläche 0-180cm
Rasengitter Fallschutzplatte
espace de chute 0-180cm
Dalle à gazon en caoutchouc

Fundament F03

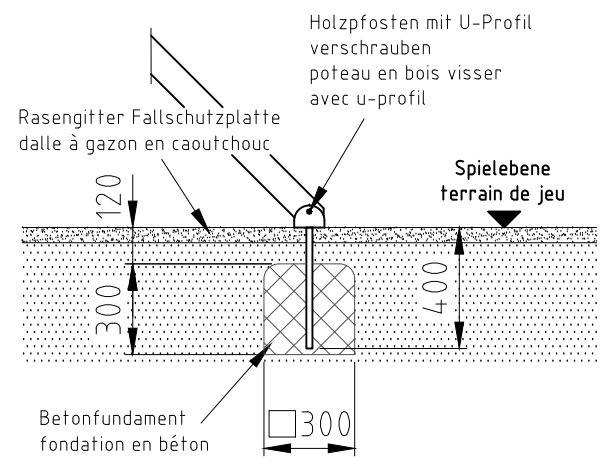

Fundament F05

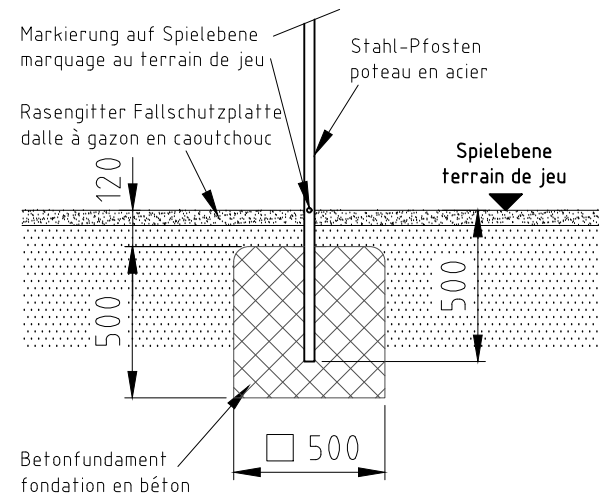

Fundament F09

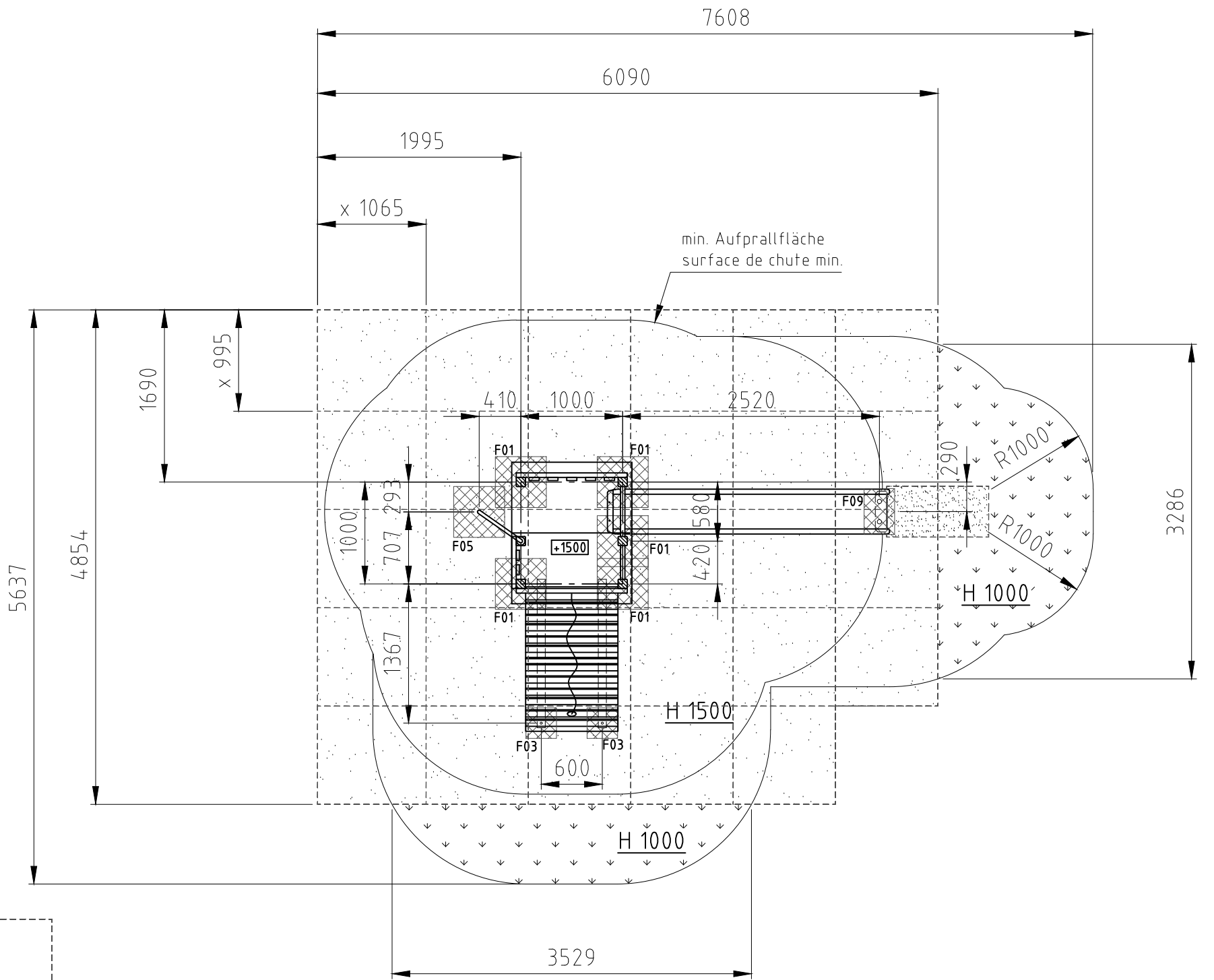
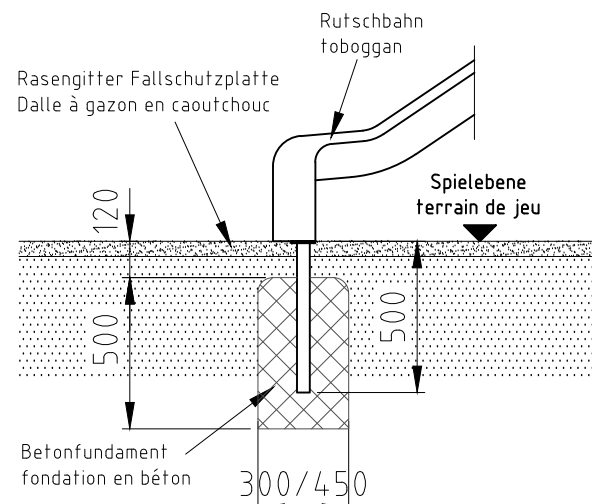

x bei Einbau der Rasengitterplatten auf Lage achten /
Lors de l'installation des dalle à gazon en caoutchouc
faites attention à la position

Norm: SN EN 1176-1: 2018 SN EN 1177: 2018	Datum	Name	Objekt: 54260-001-rg Spielturm-Kombination
	Gez	ms	
Sachbearbeiter			Auftraggeber: Rasengitter Fallschutzplatte / Dalle à gazon en caoutchouc
Spiel- und Sportgeräte AG CH-6212 St. Erhard Tel 041 925 14 00 info@buerli.swiss			Fundation
			M: 1:50 Layout: 1 A3
© by www.buerli.swiss		Offerte/Auftrag:	Zeichn.-Nr.: 126430 Index: -